



PRESSURE SWITCH KIT INSTRUCTION SHEET

FACTORY-INSTALLED PRESSURE SWITCH

If the dispenser you received includes a factory-installed pressure switch, connect power leads from the dishmachine to the proper terminals in the dispenser (see dispenser wiring diagram). Make sure that the power source is on during both the wash and rinse cycles.

You must also reconfigure the provided rinse injection fitting. Disassemble and remove the internal check parts (poppet/spring or duckbill) from the rinse injection fitting so that pressure in the line will be detected by the pressure switch. Reassemble rinse injection fitting when finished.

RETROFITTING AN INTERNAL PRESSURE SWITCH

If your dispenser did not include a pressure switch, you may install an internal pressure switch per instructions below. See the diagram on the back page for additional reference.

- (1) Remove power from the dishmachine. Ensure that power is removed from the dispenser.
- (2) Disassemble and remove the internal check parts (poppet/spring or duckbill) from the rinse injection fitting so that pressure in the line will be detected by the pressure switch. Reassemble rinse injection fitting when finished.
- (3) Some dispensers will have an existing 1/2" hole located just below the output side of the rinse pump squeeze tube. If no hole exists, you can drill a hole using a 1/2" bit (use the diagram on the back page as reference).
- (4) Wrap the threads of the pressure switch with 3 - 4 turns of plumbing tape, then attach the 1/8" NPT tee fitting to the pressure switch using the provided washer and gasket (the tee should be aligned vertically).
- (5) Attach the barbed check-fitting to the top of the tee fitting, then connect the discharge end of the rinse pump squeeze tube to the barbed fitting. Cinch a tie wrap around this connection to prevent leaks.
- (6) Attach the tube fitting to the bottom of the tee fitting. Connect poly flow tubing between the tube fitting and the injection point on the dishmachine.
- (7) Wire the pressure switch per the wiring diagram in the dispenser's instruction manual.

RETROFITTING A REMOTE PRESSURE SWITCH

If your dispenser did not include a pressure switch, you may install a remote pressure switch per instructions below.

- (1) Remove power from the dishmachine. Ensure that power is removed from the dispenser.
- (2) Locate the rinse injection fitting presently installed on the dishmachine (if applicable). Near the injection point, drill a hole for the pressure switch. Drill the hole using a 11/32" bit and tap to 1/8" NPT. Wrap the threads of the pressure switch with 3 - 4 turns of plumbing tape, then install the pressure switch into the drilled/tapped hole.
- (3) Wire the pressure switch per the wiring diagram in the dispenser's instruction manual.



CAUTION: Wear protective clothing and eyewear when dispensing chemicals or other materials. Observe safety handling instructions (MSDS) of chemical mfrs.



CAUTION: To avoid severe or fatal shock, always disconnect main power when servicing the unit.



CAUTION: When installing any equipment, ensure that all national and local safety, electrical, and plumbing codes are met.

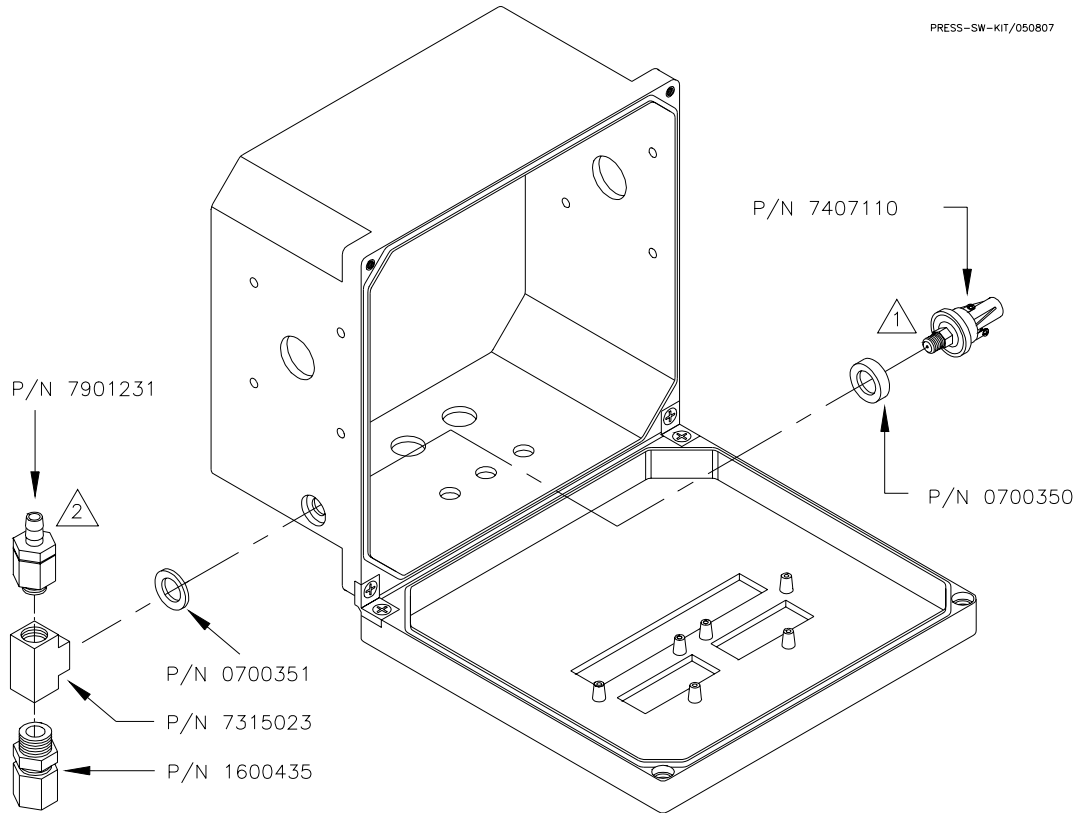

△2 SECURE BARB TO SQUEEZE TUBE WITH TIE WRAP.

△1 WRAP THREADS OF PRESSURE SWITCH WITH 3-4 TURNS OF PLUMBING TAPE.

DISCLAIMER

Knight LLC does not accept responsibility for the mishandling, misuse, or non-performance of the described items when used for purposes other than those specified in the instructions. For hazardous materials information consult label, MSDS, or Knight LLC. Knight products are not for use in potentially explosive environments. Any use of our equipment in such an environment is at the risk of the user, Knight does not accept any liability in such circumstances.

WARRANTY

All Knight controls and pump systems are warranted against defects in material and workmanship for a period of ONE year. All electronic control boards have a TWO year warranty. Warranty applies only to the replacement or repair of such parts when returned to factory with a Knight Return Authorization (KRA) number, freight prepaid, and found to be defective upon factory authorized inspection. Bearings and pump seals or rubber and synthetic rubber parts such as "O" rings, diaphragms, squeeze tubing, and gaskets are considered expendable and are not covered under warranty. Warranty does not cover liability resulting from performance of this equipment nor the labor to replace this equipment. Product abuse or misuse voids warranty.

FOOTNOTE

The information and specifications included in this publication were in effect at the time of approval for printing. Knight, LLC reserves the right, however, to discontinue or change specifications or design at any time without notice and without incurring any obligation whatsoever.

KNIGHT LLC, A Unit of IDEX Corporation (www.knightequip.com)

Knight Headquarters
Tel: 949.595.4800
Fax: 949.595.4801

USA Toll Free
Tel: 800.854.3764
Fax: 800.752.9518

Knight Canada
Tel: 905.542.2333
Fax: 905.542.1536

Knight Europe
Tel: 44.1293.615.570
Fax: 44.1293.615.585

Knight Australia
Tel: 61.2.9725.2588
Fax: 61.2.9725.2025

Knight N. Asia
Tel: 82.2.3481.6683
Fax: 82.2.3482.5742

Knight S. Asia
Tel: 65.6763.6633
Fax: 65.6764.4020